

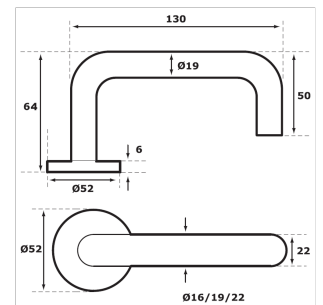

ABLOY 60-0319-SSS Futura Lever Handle Pair To Suit the EL560 & EL561



Description

The Abloy 60-0319-SSS Futura Lever Handle Pair set is a lever on a round rose and has a Satin Stainless Steel finish. This product has stainless steel fixing plates with 2 pairs of holes placed to suit DIN or Scandinavian standards, and a 1.25mm thick stainless steel tube to prevent overload of the lockcase, with no need for a support spring. Its handle dimensions meet the requirements of both the Disability Discrimination Act (1995) and the Equality Act (2010), and the lever meets the BS EN179 requirements for escape levers. This Handle Pair is ideal for fire escape doors thanks to its 'Return to door' design. The

Abloy 60-0319-SSS Futura Handle Pair set is supplied with relevant escutcheons, roses/plates and fixings.

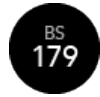

Complies to BS EN 179

Features

- Meets BS EN179 requirements for escape levers
- Supplied with relevant escutcheons, roses/plates and fixings
- 1.25mm thick stainless steel tube to prevent overload of the lockcase, with no need for a support spring
- Stainless steel fixing plates with 2 pairs of holes placed to suit DIN or Scandinavian standards
- Ideal for fire escape doors ('Return to door' design)
- Handle dimensions meet requirements of the Disability Discrimination Act (1995) and Equality Act (2010)
- Abloy Security

Product Table



L23574
60-0319-SSS

